

BACKSHELL KIT INCLUDES:

(2) BACKSHELL HALVES

(2) 4-40 THUMBSCREWS

(2) HOUSING SCREWS

(1) SET OF COMPRESSION INSERTS - (9 POSITION ~ 37 POSITION)

DIAMETERS: 4mm (.157"), 5mm (.197"), 7mm (.276"), 9mm (.351")

(1) SET OF COMPRESSION INSERTS - (50 POSITION)

DIAMETERS: 11mm (.433"), 12.5mm (.492"), 14mm (.551"), 15mm (.591")

NOTE: 9 POSITION HAS ONLY 1 THUMBSCREW

(OPPOSITE CABLE ENTRY)

DIMENSIONS (mm/in)					
SIZE:	A $\pm .25$ $\pm .010$	B $\pm .13$ $\pm .005$	C $\pm .25$ $\pm .010$	D $\pm .25$ $\pm .010$	E
9	31.00	24.99	36.30	14.50	13.00
	1.220	0.984	1.429	0.571	0.512
15	39.50	33.32	40.30	14.50	13.00
	1.555	1.312	1.587	0.571	0.512
25	53.20	47.04	40.30	14.50	13.00
	2.094	1.852	1.587	0.571	0.512
37	69.70	63.50	40.30	14.50	13.00
	2.744	2.500	1.587	0.571	0.512
50	67.40	61.11	44.90	17.40	17.00
	2.654	2.406	1.768	0.689	0.669

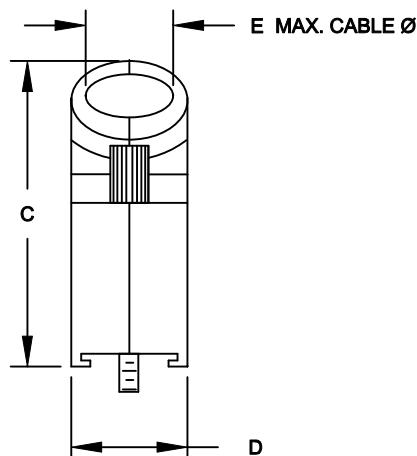
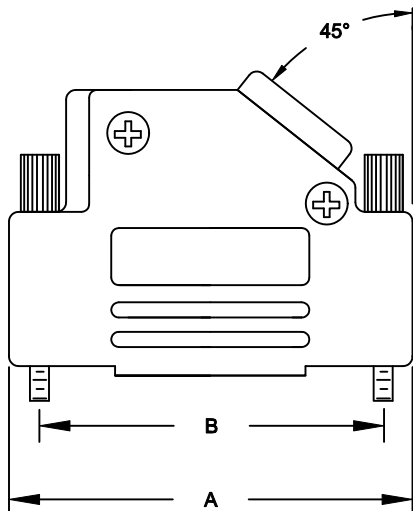

ORDERING INFORMATION

SIZE:	P/N KITTED:	PRODUCT CODE:
9-WAY	6560-0116-11	MHD45ZK-9-BK-K
15-WAY	6560-0116-12	MHD45ZK-15-BK-K
25-WAY	6560-0116-13	MHD45ZK-25-BK-K
37-WAY	6560-0116-14	MHD45ZK-37-BK-K

SIZE:	P/N BULK:	PRODUCT CODE:
9-WAY	6561-0116-11	MHD45ZK-9-BK
15-WAY	6561-0116-12	MHD45ZK-15-BK
25-WAY	6561-0116-13	MHD45ZK-25-BK
37-WAY	6561-0116-14	MHD45ZK-37-BK

PLASTIC: DIE CAST ZINC ALLOY

PLATING: BLACK OXIDE

4-40 THUMBSCREWS: STEEL - BLACK OXIDE PLATED

HOOD SCREWS: STEEL - BLACK OXIDE PLATED

COMPRESSION INSERTS: ABS UL RECOGNIZED

OPERATING TEMP: -40°C TO +120°C

THESE DRAWINGS AND SPECIFICATIONS ARE THE PROPERTY OF MH CONNECTORS LTD. AND SHALL NOT BE REPRODUCED, COPIED OR USED AS THE BASIS FOR THE MANUFACTURE OR SALE OF APPARATUS WITHOUT WRITTEN PERMISSION.

DRAWN P. JENKINS	DATE 03-14-12
----------------------------	-------------------------

APPROVED D. CROFT	DATE 03-14-12
-----------------------------	-------------------------

SCALE NTS	SHEET 1	OF 1	REV: A
---------------------	-------------------	----------------	------------------

DRAWING No
MHD45ZK-BK SERIES

RoHS COMPLIANT



MH CONNECTORS LTD.