

SMALL FOOT PRINT AND LOW PROFILE POWER INDUCTORS [CXTU0212 Series]

Features

- Shielded power inductors with the smallest footprint 2.65 x 2.65 x 1.2mm
- Low noise and flux by closed magnetic path structure
- RoHS Compliant

Applications

- DC-DC converters for
- Cellular phones, PDAs, Digital still cameras
- Digital video cameras, and others



Dimensions/Land pattern(for ref.)<mm>

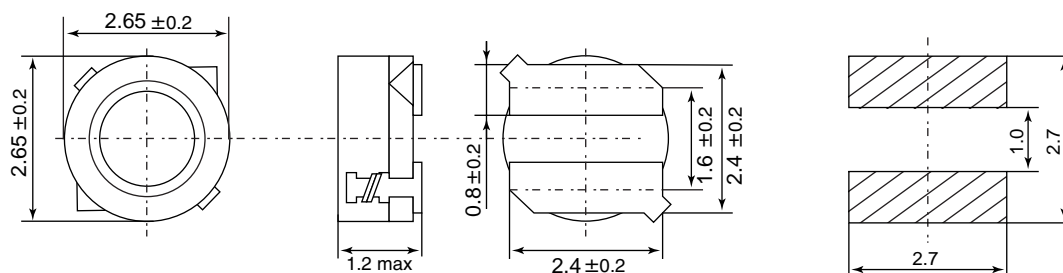

Inductance vs. DC bias current

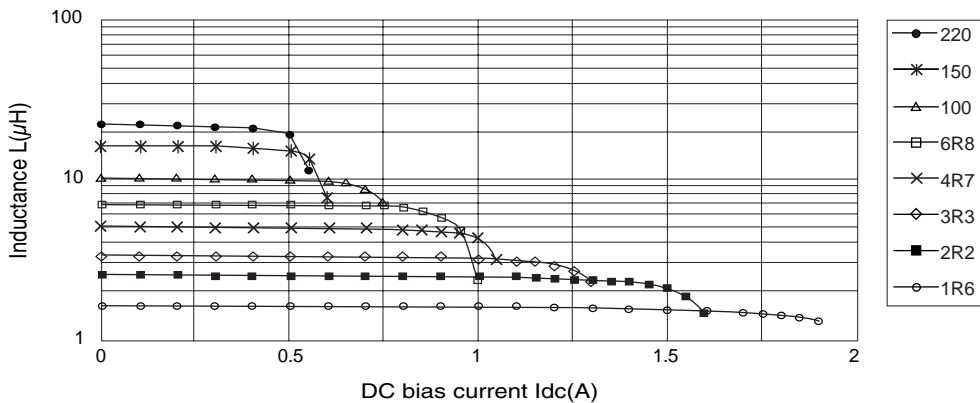

Part number list · Specifications

(Typical)

Series	Part number	Inductance L (μH) (1)	DC resistance Rdc(Ω) (2)	Rated current Idc1 / Idc2(A) (3)	Operating temperature range Ta() (4)
CXTU0212	CXTU0212-1R6	1.6±20%	0.12	1.30/1.80	-25~100
	CXTU0212-2R2	2.2±20%	0.18	1.10/1.50	
	CXTU0212-3R3	3.3±20%	0.26	0.90/1.25	
	CXTU0212-4R7	4.7±20%	0.40	0.70/1.00	
	CXTU0212-6R8	6.8±20%	0.53	0.65/0.90	
	CXTU0212-100	10±20%	0.81	0.50/0.70	
	CXTU0212-150	15±20%	1.45	0.40/0.55	
	CXTU0212-220	22±20%	2.14	0.35/0.45	

Note : (1)Ta=25、Idc=0mA (2)Ta=25 (3)Idc1:Temperature rise T 40、Idc2:Inductance change ratio | L/LI 20% (4)Including temperature rise Custom specifications are available.

POWER INDUCTORS