

THIS IS A C.A.D. GENERATED DRAWING  
DO NOT MAKE MANUAL REVISIONS TO MASTER.

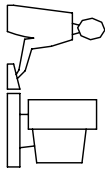

\* UNLESS OTHERWISE SPECIFIED TOLERANCES  
ON DECIMAL IS: ANGLE ± 1°  
.XX ± 0.35  
UNIT: MM

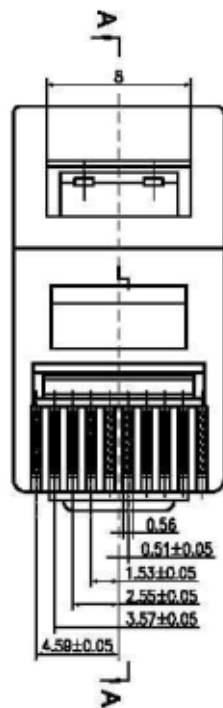

SECTION A-A

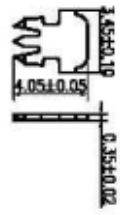
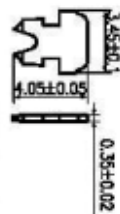
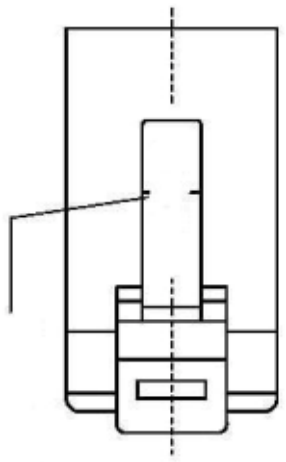
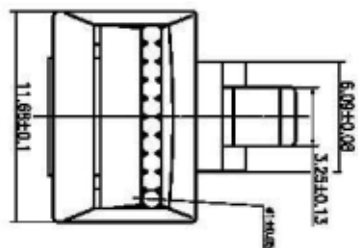
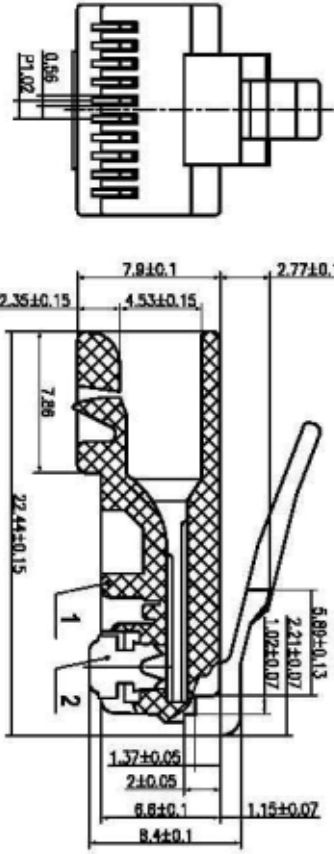

Electrical:  
Contact current rating: 1.5Amps  
Dielectric withstanding voltage: 500VAC  
Insulation resistance: 1000 MegOhms Min.  
Contact resistance: 30 MilliOhms Max  
Operating temperature: -55 °C to +85 °C

Materials:  
Contacts: Copper alloy  
Insulator: Thermoplastic PA9T UL 94V-0  
Shell: Steel  
Gold plating: 50 microinch

THESE DRAWINGS AND SPECIFICATIONS ARE THE PROPERTY OF MH CONNECTORS LTD. AND SHALL NOT BE REPRODUCED, COPIED OR USED AS THE BASIS FOR THE MANUFACTURE OR SALE OF APPARATUS WITHOUT WRITTEN PERMISSION.

DRAWN	DATE
JDHNNY	08-20-12
APPROVED	DATE

SCALE	SHEET	OF	REV:
1:1	1	DF 1	A



THIS SERIES FULLY CONFORMS TO THE  
EUROPEAN UNION DIRECTIVES 2002/95/EC  
AND 2002/96/EC FOR ROHS COMPLIANCY.



MH CONNECTORS LTD.

DRAWING No  
MHRJ4810P10CR